

CONTRACT PLANS COMPONENTS

ROADWAY PLANS

TAMPA HILLSBOROUGH
EXPRESSWAY AUTHORITY

CONTRACT PLANS

PROJECT ID: O-00419

HILLSBOROUGH COUNTY (10002)

E. TWIGGS STREET UTILITY ADJUSTMENTS

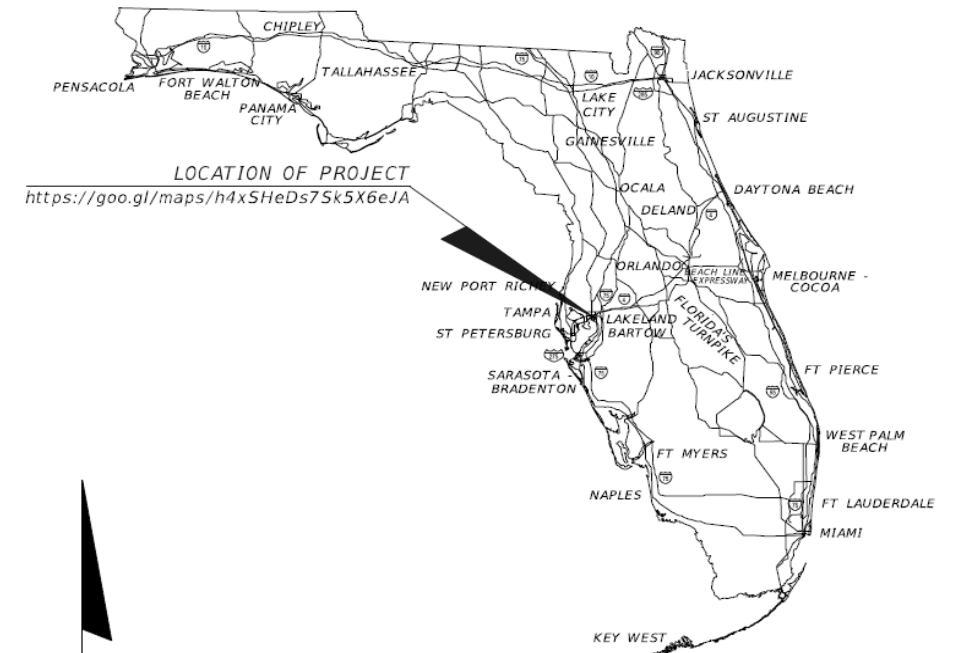

INDEX OF ROADWAY PLANS

SHEET NO.	SHEET DESCRIPTION
1	KEY SHEET
2	SIGNATURE SHEET
3	GENERAL NOTES
UTV-1	SUMMARY OF VERIFIED UTILITIES
4 - 5	UTILITY ADJUSTMENT TYPICAL SECTION* ROADWAY PLAN*

* PLAN SHEETS PROVIDED FOR INFORMATION ONLY

Includes Level 3 CenturyLink

Verizon
Business
MCI/XO
RGB
Markups

James Barra

MCI/Verizon Services Operations
Engineer III, Spec-Ntwk Eng & Ops
Engineering OSP BAU & One Fiber
MCI Communications Services
Cell 813-928-9881
James.Barra1@VerizonWireless.com

Thomas Darling

MCI Local Coordinator – OSP Engineer
WD Communications Inc
727-804-3870 (C)

GOVERNING STANDARD PLANS:

Florida Department of Transportation, FY2018/19 Standard Plans for Road and Bridge Construction and applicable Interim Revisions (IRs).

Standard Plans for Road Construction and associated IRs are available at the following website: <http://www.fdot.gov/design/standardplans>

GOVERNING STANDARD SPECIFICATIONS:

Florida Department of Transportation, July 2018 Standard Specifications for Road and Bridge Construction at the following website: <http://www.fdot.gov/programmanagement/Implemented/SpecBooks>

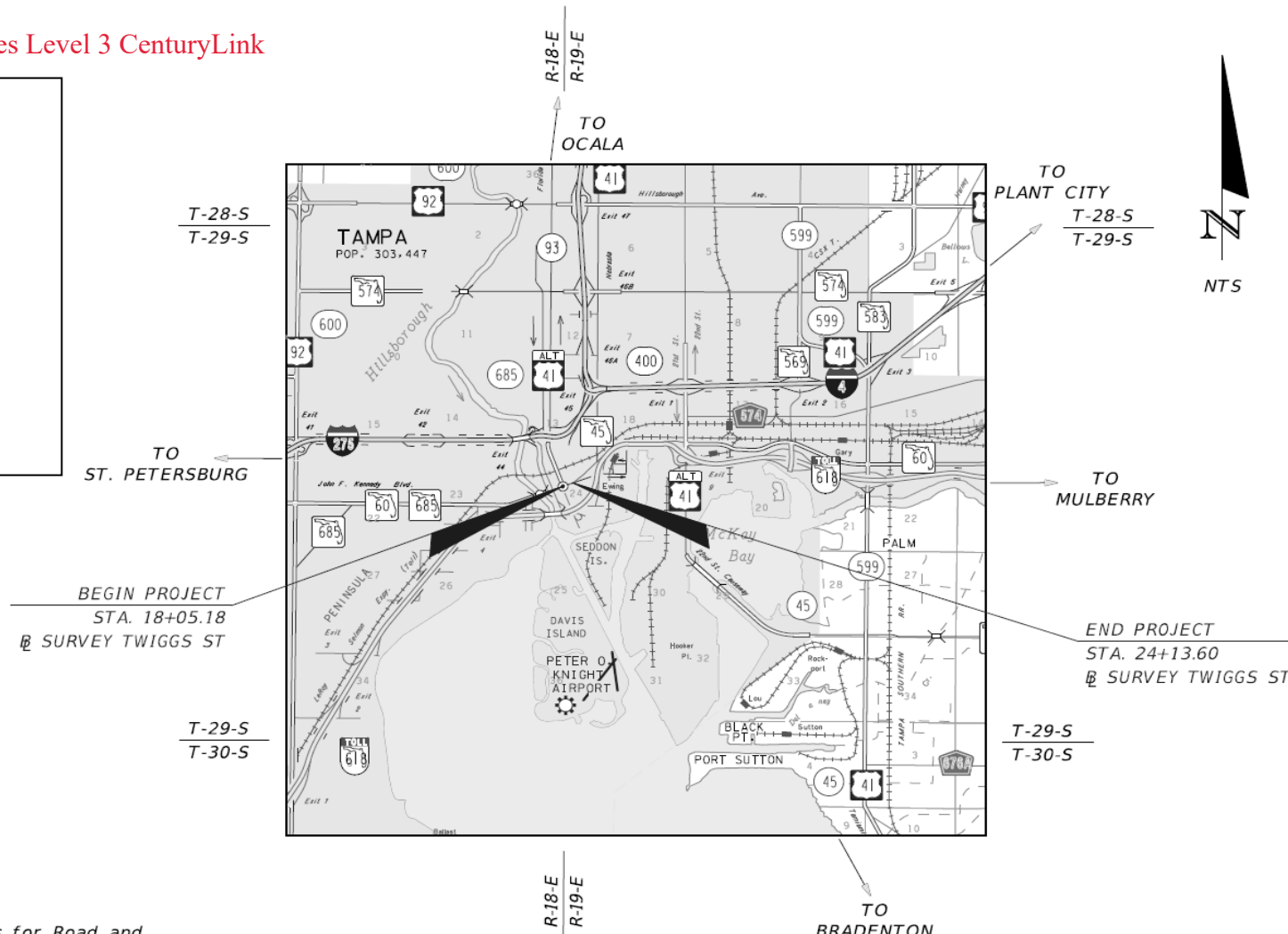

ROADWAY PLANS
ENGINEER OF RECORD:

MEGAN M. TETRO, P.E. NO.: 76120
WANTMAN GROUP, INC.
3111 W. DR. MARTIN LUTHER KING JR. BLVD.,
SUITE 375, TAMPA, FL 33607
(813) 574-3190
CERTIFICATE OF AUTHORIZATION NO.: 6091

THEA PROJECT MANAGER:

DAVID MAY, P.E.

Page 1 of 4

CONSTRUCTION CONTRACT NO.	FISCAL YEAR	SHEET NO.
		1

THE OFFICIAL RECORD OF THIS SHEET IS THE ELECTRONIC FILE DIGITALLY SIGNED AND SEALED UNDER RULE 61G15-23.004, F.A.C.

CURVE DATA SR45-1
 PI STA. = 106+46.41
 Δ = 21° 30' 38" (RT)
 D = 24° 23' 33"
 T = 44.62
 L = 88.18
 R = 234.89
 PC STA. = 106+01.79
 PT STA. = 106+89.98
 3x1.5" BURIED FIBER OPTIC CABLE / TO REMAIN
 FIBERLIGHT

MCI / Verizon Business
 (Old Western Union Manhole System)

MCI / Verizon Business
 (Old ICI network W/ Fiberlight)

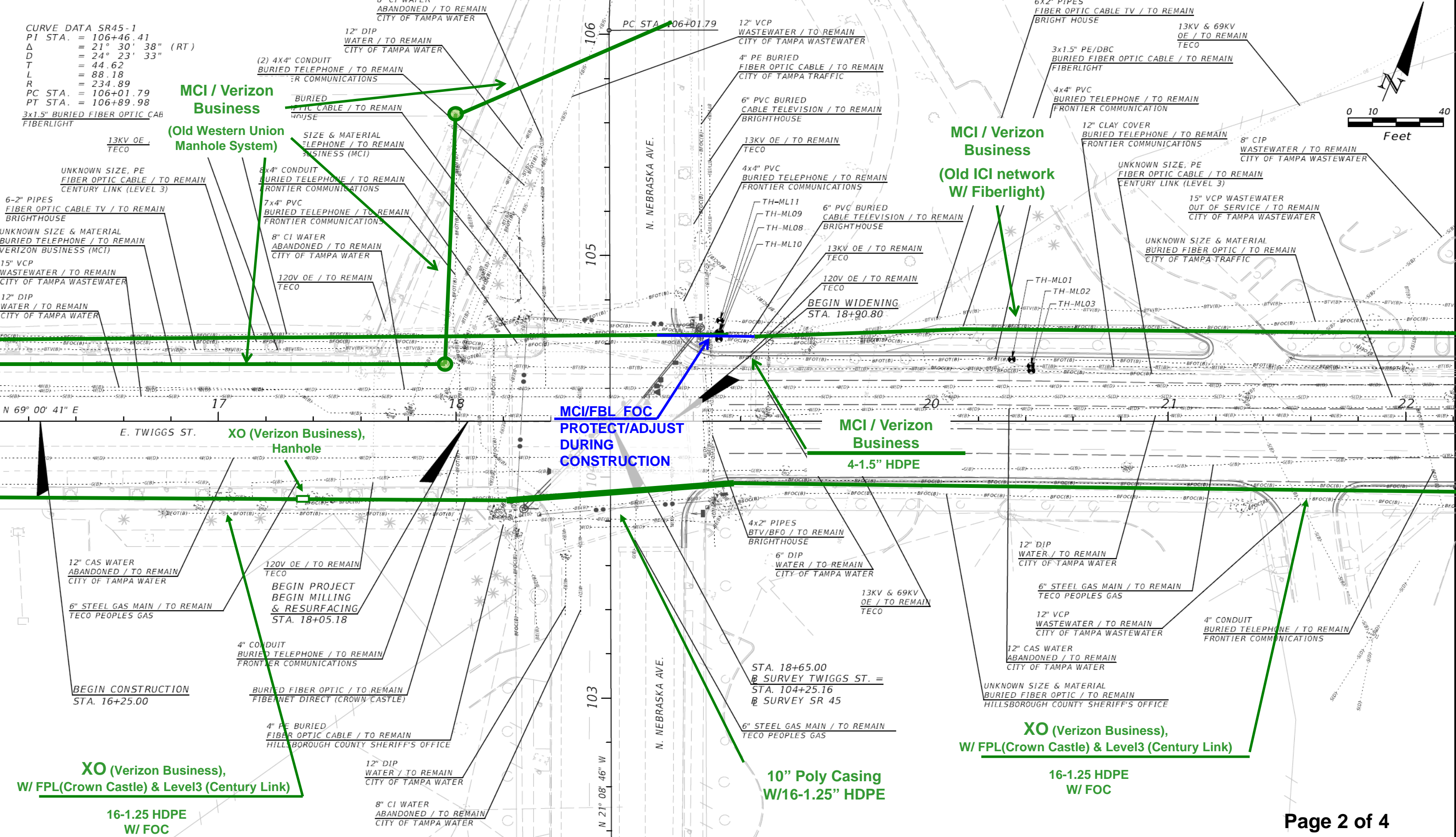

MCI/FBL FOC
 PROTECT/ADJUST
 DURING
 CONSTRUCTION

XO (Verizon Business),
 W/ FPL(Crown Castle) & Level3 (Century Link)
 16-1.25 HDPE
 W/ FOC

XO (Verizon Business),
 W/ FPL(Crown Castle) & Level3 (Century Link)
 16-1.25 HDPE
 W/ FOC

REVISIONS			
DATE	DESCRIPTION	DATE	DESCRIPTION

MEGAN M. TETRO, P.E.
 FLORIDA PE NO. 76120
 WANTMAN GROUP, INC.
 3111 W. MARTIN LUTHER KING JR. BLVD.,
 SUITE 375, TAMPA, FL 33607
 CERTIFICATE OF AUTHORIZATION NO. 6091

TAMPA HILLSBOROUGH EXPRESSWAY AUTHORITY		
ROAD	COUNTY	CONTRACT NO.
TWIGGS	HILLSBOROUGH	000419

UTILITY ADJUSTMENT (1)

SHEET NO.
4

THE OFFICIAL RECORD OF THIS SHEET IS THE ELECTRONIC FILE DIGITALLY SIGNED AND SEALED UNDER RULE 61G15-23.004, F.A.C.

MCI / Verizon Business
(Old Western Union Manhole System)

MCI / Verizon Business
(Old ICI network With ACS)

MCI / Verizon Business
4-1.5" HDPE

XO (Verizon Business),
W/ FPL(Crown Castle) & Level3 (Century Link)

16-1.25 HDPE
W/ FOC

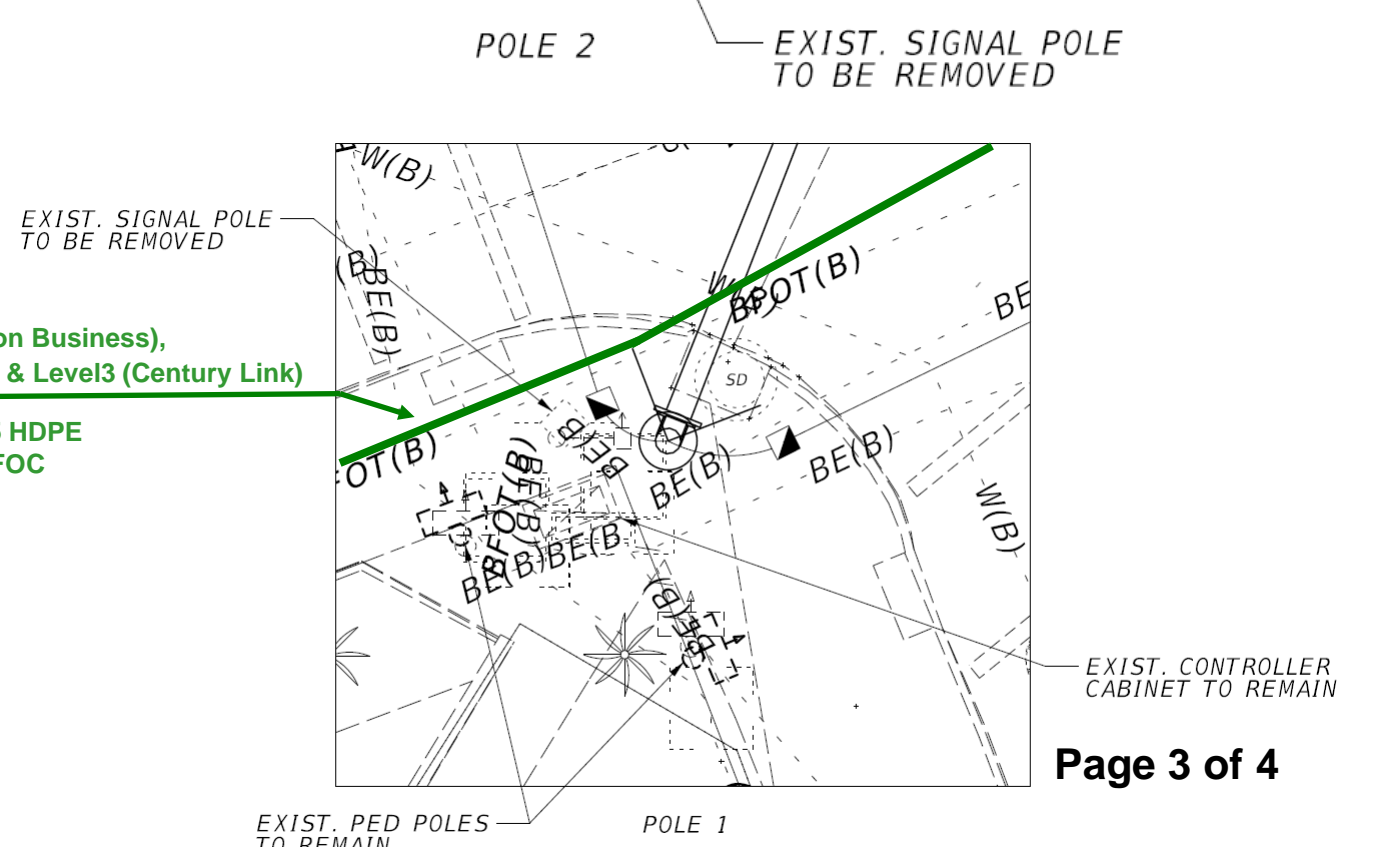
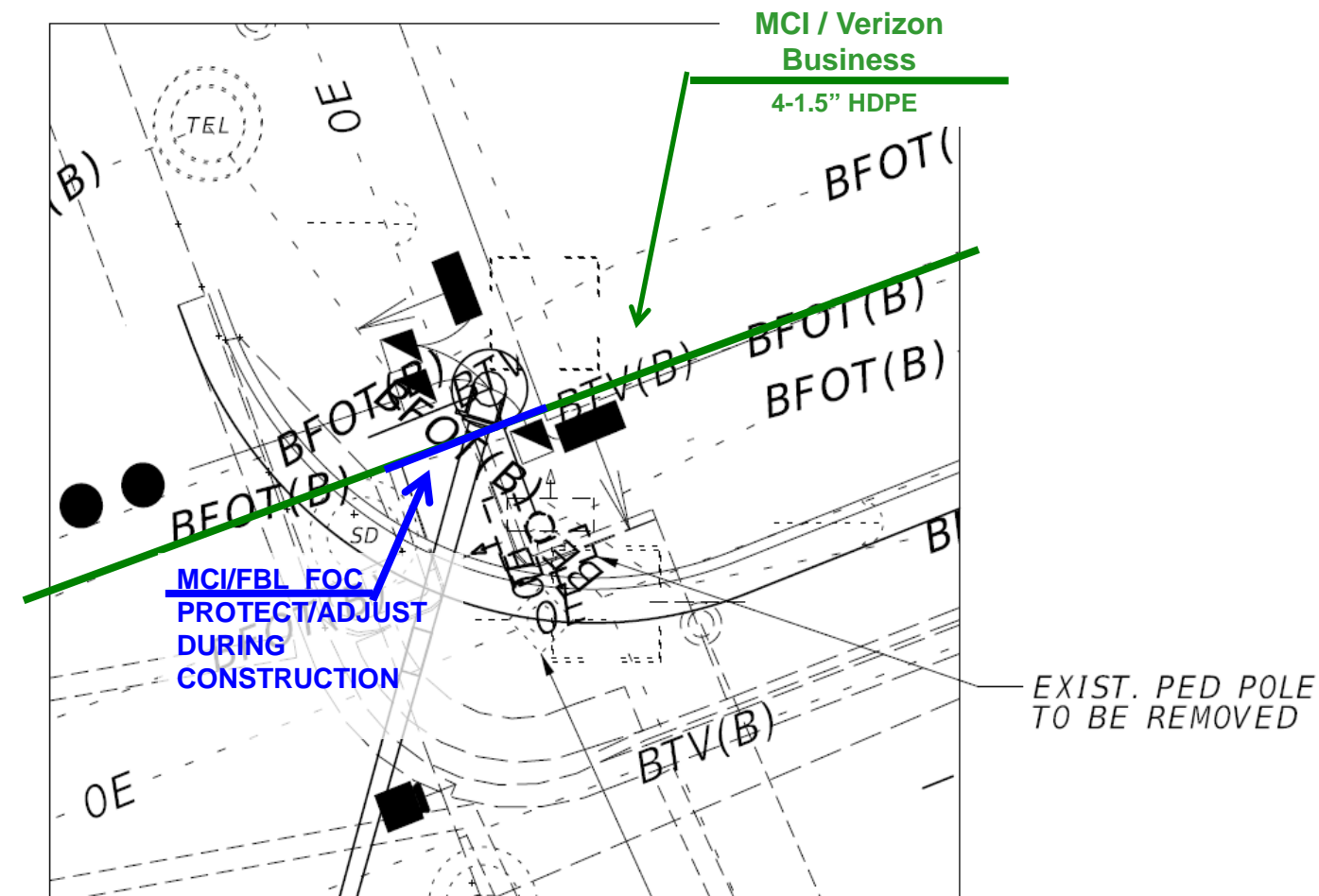
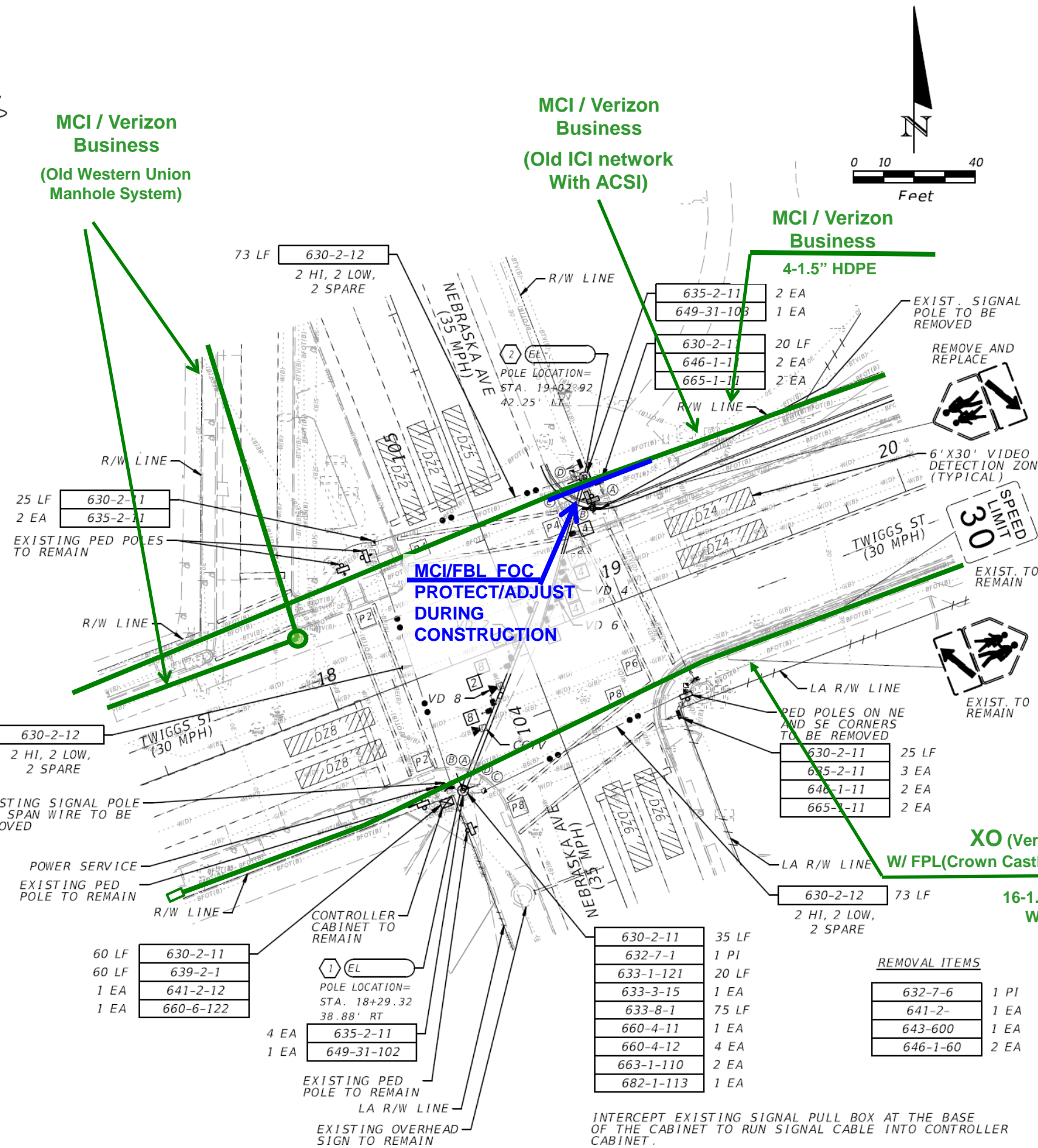

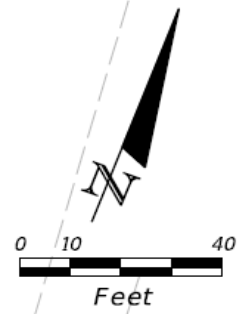
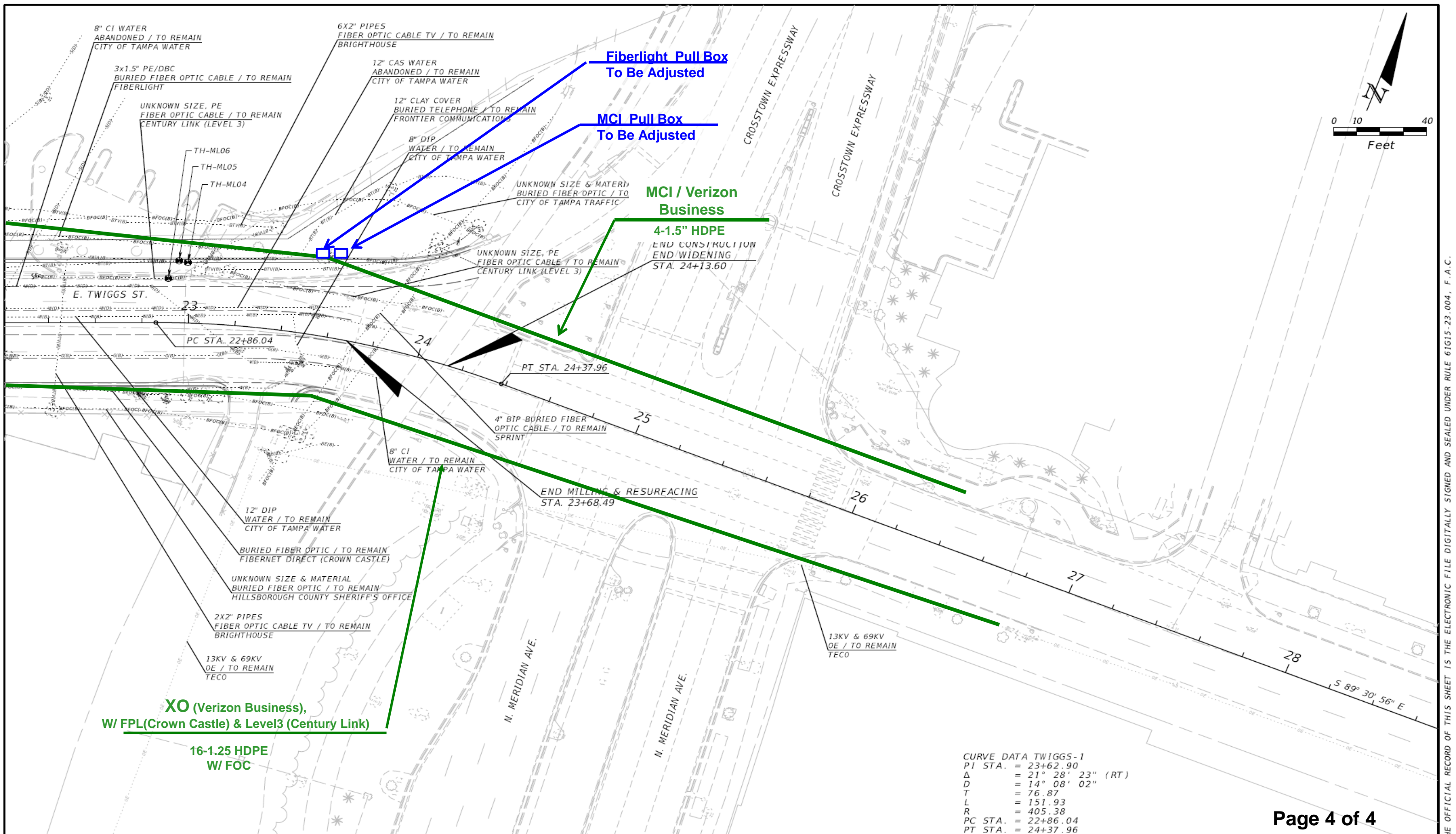

CURVE DATA TWIGGS-1
 PI STA. = 23+62.90
 Δ = 21° 28' 23" (RT)
 D = 14° 08' 02"
 T = 76.87
 L = 151.93
 R = 405.38
 PC STA. = 22+86.04
 PT STA. = 24+37.96

REVISIONS			
DATE	DESCRIPTION	DATE	DESCRIPTION

MEGAN M. TETRO, P.E.
 FLORIDA PE NO. 76120
 WANTMAN GROUP, INC.
 3111 W. MARTIN LUTHER KING JR. BLVD.,
 SUITE 375, TAMPA, FL 33607
 CERTIFICATE OF AUTHORIZATION NO. 6091

TAMPA HILLSBOROUGH EXPRESSWAY AUTHORITY		
ROAD	COUNTY	CONTRACT NO.
TWIGGS	HILLSBOROUGH	000419

UTILITY ADJUSTMENT (2)

SHEET NO.
5

THE OFFICIAL RECORD OF THIS SHEET IS THE ELECTRONIC FILE DIGITALLY SIGNED AND SEALED UNDER RULE 61G15-23.004, F.A.C.